

1. BEFORE YOU START

1

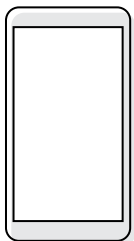

2

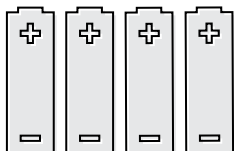

3

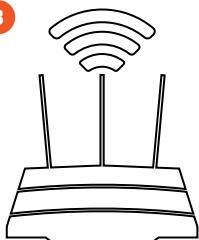

4



Scan this code
or search for
Cocoon Connect

Before you begin, make sure you have:

1. A mobile device - Android (V4.1 or later) or iOS (V8 or later)
2. 4 x AA batteries installed in the Outdoor Camera
3. A Wi-Fi connection (have the password handy)
4. Download the Cocoon Connect app

For detailed instructions and videos, visit www.cocoonproducts.com.au

2. APP SETUP

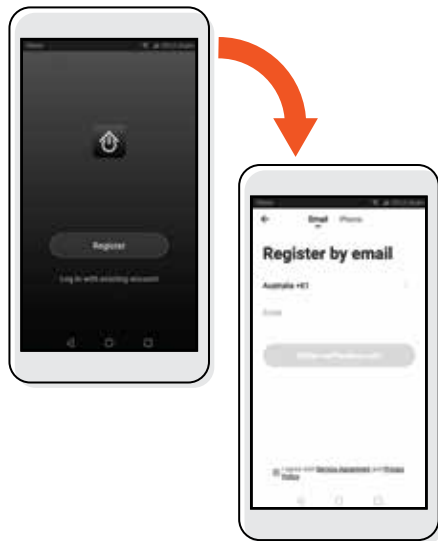

First time users:
Register an account and follow the remaining prompts on screen

3. CONFIRM PAIRING MODE

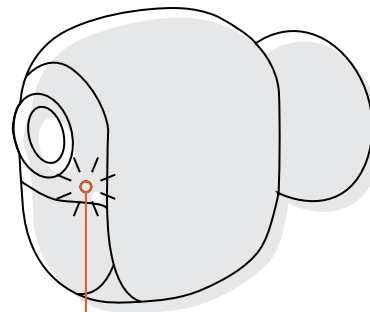

INDICATOR
LIGHT

- LED indicator light will be flashing red / blue. The camera will say 'The camera is now ready to begin pairing'
- If you have issues with this step, hold down the internal reset button for 5 seconds and start again
- If you are still having issues, please check your instruction manual

4. ADD THE OUTDOOR CAMERA



1. ADD NEW
DEVICE

2. SELECT SMART
CAMERA (IN
SECURITY & SENSOR)

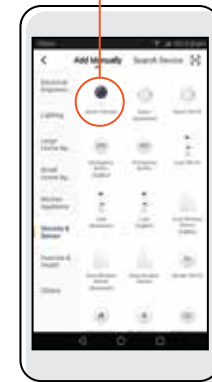

5. CONNECT OUTDOOR CAMERA TO WI-FI

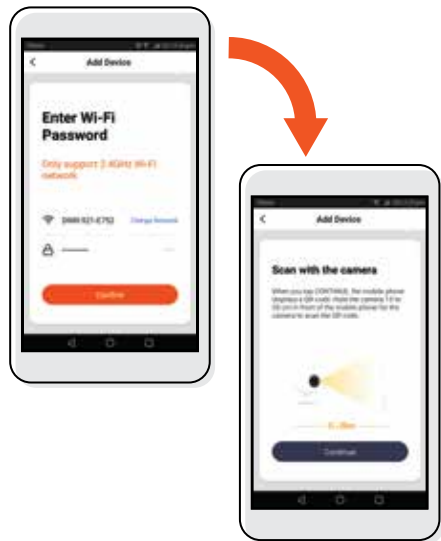

1. Enter Wi-Fi password and select confirm
2. Scan with the camera

If you have any issues with this step, ensure your Wi-Fi password is correct
If you are still having issues, please check your Instruction Manual

6. SCAN QR CODE WITH CAMERA 7. CAMERA ADDED SUCCESSFULLY

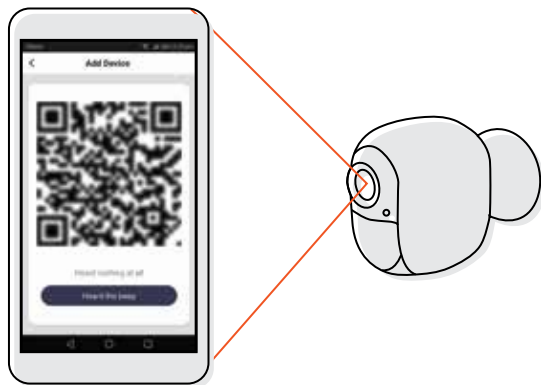

1. Hold the mobile phone 15 to 20cm in front of the Outdoor Camera for the camera to scan the QR code
2. Camera will beep when the code is scanned
3. Press 'Heard the Beep'

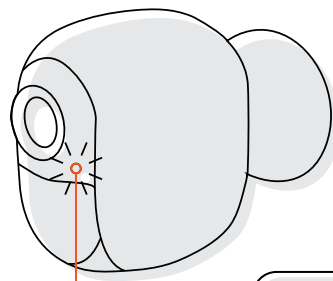

LED WILL
STOP FLASHING

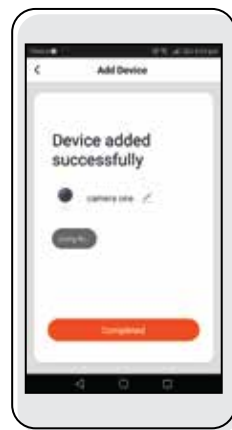

8. CONTROL YOUR OUTDOOR CAMERA

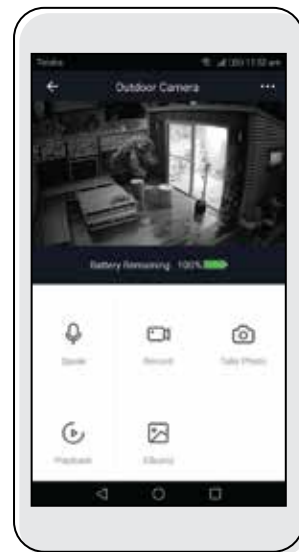

Use, manage and control your Smart Outdoor Camera from the Cocoon Connect app